

# 2024

## OVERVIEW



**MURRAYWOOD**  
CONSTRUCTION LTD

## 1996

In April 1996, Billy Murray and Tim Wood established Murraywood Construction and began trading the following month.

## 1997

Initially setting off as a labour and plant contractor with a turnover of £1.45m in the first year.

## 2000's

After expanding organically during their formative years, Murraywood Construction matured into providing a full groundworks service.

## 2016

To ensure the smooth running of our business, in 2016 a number of long-serving staff members were promoted to join Billy and Tim as Directors in 2016 with several others promoted to senior positions within the business.

## 2025

Now based in St Helens and progressing towards our 30th anniversary in 18 months-time, Murraywood are a well-established and experienced groundworks contractor who operate predominantly in the North West of England. We have expanded over the years to now include our own in-house Health & Safety, Accounting and Business Support teams.



# 2024

## AT A GLANCE

12  
Projects Over  
The Year

2  
CITB Mentors

3  
Degree Apprentices

2  
New MHFA's

1  
New Apprentice

2  
Students for Work  
Experience

8  
Careers Events

# PROJECT SPOTLIGHTS



# FIRST STREET

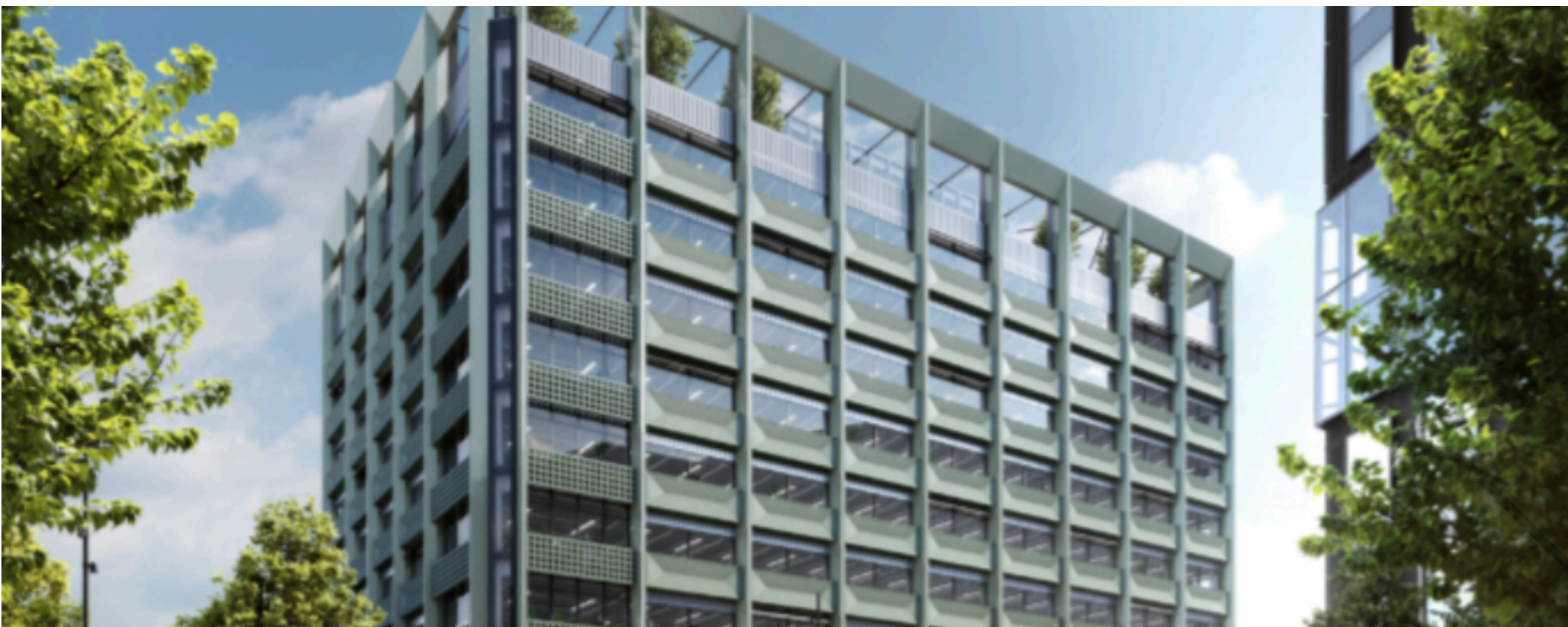

**CLIENT: BAM**  
**DURATION: 108 WEEKS**



## OVERVIEW:

Government departments, including Highways England, are relocating to a new, sustainable office on First Street, as Piccadilly Gate makes way for the HS2 station. With 700 civil service roles moving from London, this building will be the most sustainable building in Manchester City Centre, so we are proud to be a part of this as it aligns with our commitment to achieving net carbon zero.

## WHAT WE DID:

- Site investigation and remediation with asbestos removal.
- Bulk earthworks and piling mat construction with piling attendance.
- Construction of the capping beam and basement excavation.
- Foundations drainage
- Slipping the core
- Waterproofing the basement
- Forming basement walls and slabs.
- Installing pre cast stairs and landings.
- Casting the upper floor slabs on to metal decks.

# BYRCHALL HIGH SCHOOL



**CLIENT: BAM**  
**DURATION: 44 WEEKS**



## OVERVIEW:

We worked with BAM on Byrchall High School to create a new eco school. This project began as the school received a portion of the Department for Education's £1bn School Rebuilding Programme. The new secondary school welcomes pupils aged between 11-16 years and was one of the first of 50 new "eco and self-sustainable schools" to be built in the UK over a three year period.

## WHAT WE DID:

- Substructure (foundation & retaining walls)
- Installed drainage
- Ground floor slab
- Insitu concrete, amphitheatre seating area.
- Hard landscaping
- Road & carpark construction
- Underground service ducting, LV, Gas, Water & Street lighting.
- Cut & Fill to soft landscape areas, placing topsoil and enhancing the environment with newly planted trees, turf, shrubs & seed.



# FURNESS QUAY



**CLIENT:** LATIMER BY CLARION HOUSING GROUP  
**DURATION:** 26 WEEKS



## OVERVIEW:

Murraywood Construction were appointed Principal Contractor on our Furness Quay project, this project involved two impressive residential towers, comprising a total of 270 apartments and townhouses. This distinctive collection of one, two and three bedroom apartments and duplexes are located in the heart of Salford Quays with views overlooking the water and Old Trafford.

## WHAT WE DID:

- Installed 80m<sup>3</sup> attenuation tank, land drains, swales, and 400m ACO channels.
- Conducted drainage remediation, water mains work, and vacuum excavation.
- Installed 2000m of external ducting and cabling for street lighting and CCTV.
- Supplied and installed 3 Turvec cycle shelters, 146m balustrade, 400m<sup>2</sup> self-binding gravel, 2000m<sup>2</sup> tarmac, and 20m gabion baskets.
- Delivered soft and hard landscaping, including benches, bollards, 800m kerbs, 2000m<sup>2</sup> plaza paving, and granite staircases.
- Constructed RC concrete retaining walls with brickwork, timber cladding, and a new brick boundary wall on Trafford Road.

# SAINT GABRIELS



**CLIENT:** MCLAREN CONSTRUCTION GROUP  
**DURATION:** 34 WEEKS



## OVERVIEW:

We are working with McLaren Construction Group on a redevelopment and restoration project that proposes around 319 student bedrooms across two new blocks and the revamped St Gabriel's and Woodthorpe halls. The new-builds on the eastern and western edges of the site would be five storeys in height at their tallest.

## WHAT WE DID:

- Preserving exterior walls of listed buildings to maintain historical integrity.
- Removing roofs and interior walls to create desired room sizes.
- Excavating lift pits and water pits to support reinforced foundations.
- Preparing and casting reinforced suspended slab and sub-station slab.
- Installing drainage and ducting.
- Engaging a specialist contractor for gas/water-proof membrane works.
- Installing stone formations for MEWP runs to improve accessibility.



# SOCIAL VALUES

During 2024, we participated in a number of social value events to support the communities that we work in. Whether through careers events or contributing to charities close to our heart, we truly enjoy giving back to the community.

For our 2024 overview, we chose our HMP Styal Visit to be our focus, acknowledging the significance of such events in addressing the increasing number of women entering the construction workforce.

Towards the end of the year, Karen & Shannon spent an afternoon at HMP Styal, meeting the women who were about to start a Construction Training Programme run by Procure Plus within the prison. It was inspiring to see such a positive attitude toward construction as a career option from the women that they met. Their knowledge of various trades in the industry and eagerness to learn more was refreshing and we hope the information shared about career pathways and progression motivated them. We are hopeful that we will encounter them on construction sites in the future!

Although the construction industry has traditionally been male-dominated, women now make up 15.8% of the UK's construction workforce - the highest percentage recorded to date. Programs like this training initiative play a crucial role in boosting that figure even further.

Starting in the New Year, the women will embark on a 12-week programme where they will earn their CSCS Card and develop practical skills in plastering, brickwork, and plumbing. This initiative aims to build their confidence as they enter an increasingly inclusive industry and set them on a pathway to brighter futures for themselves and their families.

Murraywood Construction is proud to support and participate in events like this that promote construction as a positive and achievable career path. We look forward to returning to HMP Styal in March to reconnect with the participants and celebrate their achievements upon completing the programme!



**HMP Styal Prison Visit**

## HEAD OFFICE

Endeavour House,  
Abbotsfield Road,  
St Helens,  
WA9 4HU



Murraywood Construction Ltd



[www.murraywood.com](http://www.murraywood.com)

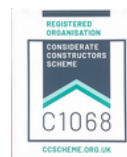

**Constructionline**  
Gold Member